

B12	A1
B9	A4
B8	A5
B7	A6
B6	A7
B5	A8
B4	A9
B1	A12

RECOMMENDED P.C.B. LAYOUT

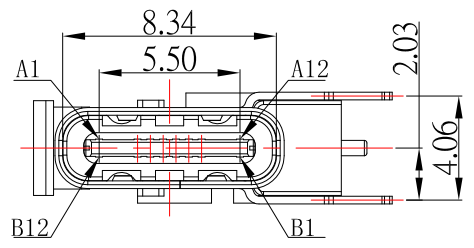

A1	GND	B12	GND
A2		B11	
A3		B10	
A4	VBUS	B9	VBUS
A5	CC1	B8	SBU 2
A6	D+	B7	D-
A7	D-	B6	D+
A8	SBU1	B5	CC 2
A9	VBUS	B4	VBUS
A10		B3	
A11		B2	
A12	GND	B1	GND

SPECIFICATIONS

- Electrical:**
- Rating: 3.0 A
 - Dielectric Withstand Voltage: 100V AC
 - Contact Resistance: 40 mΩ Max
 - Insulation Resistance: 100 MΩ Min
- Mechanical:**
- Connector Mate and Unmate Force
 - Mate force: 5~20 N
 - Unmate force: 8~20 N

SBC-160P4-20x-S410

鍍層厚度:

Blank : 1u"
2 : 15u"
3 : 30u"

- Material:**
- Housing: LCP
 - Contact: C7025
 - Shell: SUS
- Finish:**
- Contact: Plated Gold in Mating Area ;
Gold Plated on Solder Balls ;
Nickel under plated overall
 - Shell: Nickel under Plated surface layer



TOLERANCE UNLESS OTHERWISE STATED:

Up to 5	±0.2
Above 5 ~ 15	±0.3
Above 15 ~ 30	±0.4
Above 30 ~ 50	±0.5
Angle	±0.3°

3RD. ANGEL'S

UNITS: MM

DRAWN BY:	DATE	MAT'L	TITLE	CONNECTOR
Jack Lu	05/19/22			
CHECKED BY:	DATE	FINISH	MODLE	USB 3.1 側插母座 16 PIN CH6.7
Jacky Chen	05/19/22			
APPROVED BY:	DATE	SCALE	DWG NO.	SBC-160P4-20x-S410
Tony Kao	05/19/22	1 : 1		
		SHEET NO.	PART NO.	SBC-160P4-20x-S410
		1 of 1		
				SIZE: A4
				VER: R

ITEM NO.	DESCRIPTION	DRAWN	DATE